

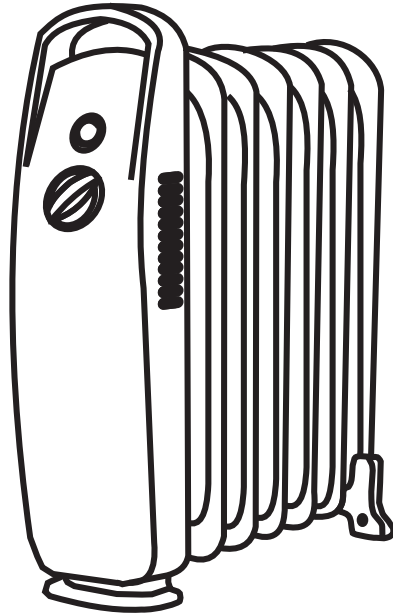

700W Oil Filled Radiator



Model NO: PM 807

INSTRUCTION MANUAL

This Product is only suitable for well insulated spaces or occasional use.

Thank you for purchasing the innovative product the PureMate 700W Oil Filled Radiator. We wish you many years of warmth with this efficient and effective product.

SAFETY INSTRUCTION

PLEASE READ THE FOLLOWING INSTRUCTIONS CAREFULLY BEFORE USING THE APPLIANCE.

- This appliance can be used by children aged from 8 years and above and persons with reduced physical, sensory or mental capabilities or lack of experience and knowledge if they have been given supervision or instruction concerning use of the appliance in a safe way and understand the hazards involved. Children shall not play with the appliance. Cleaning and user maintenance shall not be made by children without supervision..
- Children of less than 3 years should be kept away unless continuously supervised. Children aged from 3 years and less than 8 years shall only switch on/off the appliance provided that it has been placed or installed in its intended normal operating position and they have been given supervision or instruction concerning use of the appliance in a safe way and understand the hazards involved. Children aged from 3 years and less than 8 years shall not plug in, regulate and clean the appliance or perform user maintenance.
- **CAUTION** - Some parts of this product can become very hot and cause burns. Particular attention has to be given where children and vulnerable people are present.
- If the supply cord is damaged, it must be replaced by the manufacturer, its service agent or similarly qualified persons in order to avoid a hazard.

-  **WARNING:** In order to avoid overheating, do not cover the heater. The meaning of figure in marking is “DO NOT COVER”.
- The heater must not be located immediately below a socket-outlet.
- Do not use this heater in the immediate surroundings of a bath, a shower or a swimming pool.
- This appliance only for household use.
- **WARNING:** Do not use this heater in small rooms when they are occupied by persons not capable of leaving the room on their own, unless constant supervision is provided.
- This heater is filled with a precise quantity of special oil. Repairs requiring opening of the oil container are only to be made by the manufacturer or his service agent who should be contacted if there is an oil leakage. Regulations concerning the disposal of oil when scrapping the appliance have to be followed.
- Do not use this heater if it has been dropped.
- Do not use if there are visible signs of damage to the heater.
- Use this heater on a horizontal and stable surface, or fix it to the wall, as applicable.

- **WARNING:** To reduce the risk of fire, keep textiles, curtains, or any other flammable material a minimum distance of 1m from the air outlet.
- Do not attempt to repair, disassemble or modify the appliance. There are no user-serviceable parts inside.
- **CAUTION** – if using an extension lead please ensure you do not exceed the maximum rated running wattage/load of the extension lead.
- Disconnect from mains when not in use or when moving or cleaning.
- The heater is hot when in use .To avoid burns, do not let bare skin touch hot surface.
- Allow the heater to completely cool before handling or cleaning it.
- Ensure the heater is in the "0" OFF position and the power cord is unplugged from the electrical outlet before cleaning the heater.
- Do not allow water or other liquids to run into the interior of the heater, as this could create a fire and/or electrical hazard.
- Do not use any abrasive cleaners or solvents, as heater damage will occur.

COMPONENTS

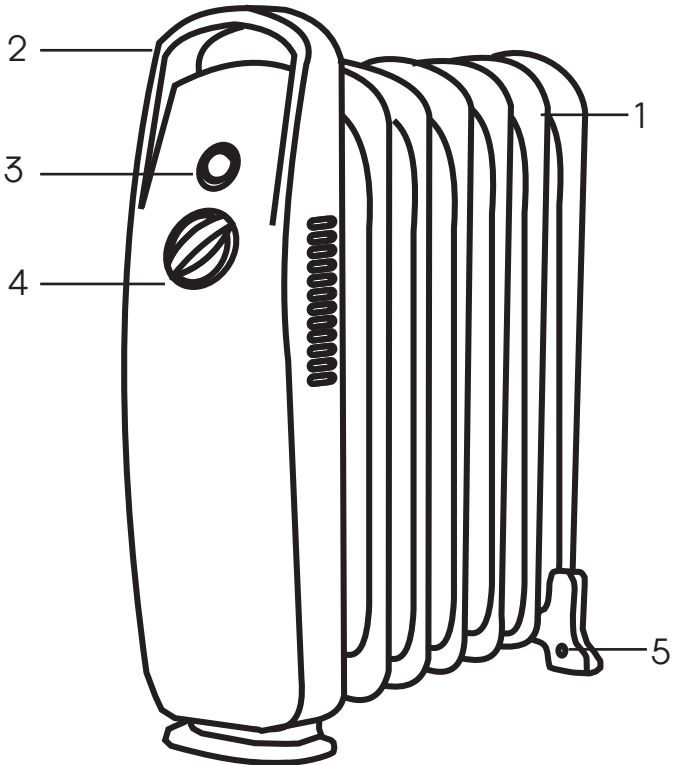

1- Radiator Fins

2- Handle

3- On/Off Power Switch
(and Indicator Light)

4- Thermostat Dial

5- Rear Stand

SAFETY CONTROLS (THERMAL CUT-OFF)

This heater is protected with overheat protection that switches off the appliance automatically in case of severe overheating. In this case, unplug the appliance, wait about 30 minutes for it to cool and remove any possible cause of overheating, eg. something covering the heater. Check for damage to the appliance, the cord and the plug. If there is no damage, plug the unit back in and switch it on as described above. If the heater still does not turn on, please contact Customer Service for assistance.

ASSEMBLY

1. Turn the heater upside down on a scratch-free and flat stable surface. (Fig. A).
2. Fit the Rear Stand into the last fin with screw hole facing outward and press it down. Secure the Rear Stand with the two accompanying screws. (Fig. B).
3. Turn the heater into its upright position before operation. (Fig. C), If you are in any doubt about installing this product, please contact Customer Service or consult a qualified electrician.

Warning: Do not use the heater without assembling the Rear Stand as this might damage your flooring.

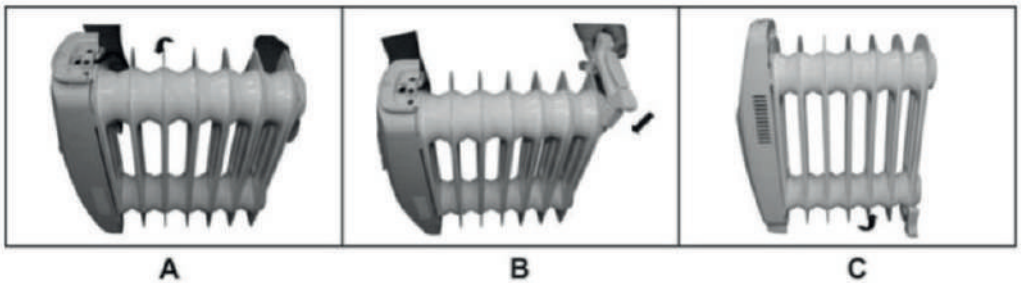

OPERATING INSTRUCTIONS

1. Place the heater upright on a flat, steady and heat-resistant surface.
2. Turn the thermostat dial anti-clockwise to LOW and ensure the power switch is '0' OFF.
3. Insert the plug into a suitable socket.
4. Turn on the heater by using the ON/OFF switch.
5. Turn the thermostat dial clockwise until you hear a click and the light turns on. Turning the thermostat clockwise will keep the radiator on until the room gets warmer. Turning it anti-clockwise will turn it off until the room has cooled to a lower temperature and then it will switch on. The radiator automatically rotates through an on-and-off cycle to maintain the current room temperature according to the thermo-
6. To turn off the heater, set the Power Switch to Off
7. Unplug the heater from the electrical outlet when it is left unattended or is not in use.

CLEANING TIPS

- Clean the exterior surface of the heater by wiping it with a soft, damp cloth.
- Store the heater in a clean, dry place when it is not in use.

Caution:

- Allow the heater to completely cool before handling or cleaning it.
- Ensure the heater is in the "0" OFF position and the power cord is unplugged from the electrical outlet before cleaning the heater.
- Do not allow water or other liquids to run into the interior of the heater, as this could create a fire and/or electrical hazard.
- Do not use any abrasive cleaners or solvents, as heater damage will occur.

SPECIFICATION

Model :	PM 807
Rated Voltage :	220-240V~ 50Hz
Power Consumption:	700W
Dimensions (L x W x H):	32(L)x 13(W) x 37.5(H) CM
Net Weight:	3.6 kg

DISPOSAL OF THIS DEVICE



At the end of the product life cycle, you should not throw this machine into the normal household garbage but bring the product to a collection point for the recycling of electrical and electronic equipment.

FIND US ONLINE



Model identifier(s): PM 807					
Item	Symbol	Value	Unit	Item	Unit
Heat output			Type of heat input, for electric storage local space heaters only (select one)		
Nominal heat output	Phom	0.7	kW	Manual heat charge control, with integrated thermostat	No
Minimum heat output(indicative)	Pmin	0.7	kW	Manual heat charge control with room and/or outdoor temperature feedback	No
Maximum continuous heat output	Pmax,c	0.7	kW	Electronic heat charge control with room and/or outdoor temperature feedback	No
Auxiliary electricity consumption			Fan assisted heat output		
At nominal heat output	elmax	N/A	kW	Type of heat output/room temperature control (select one)	
At minimum heat output	elmin	N/A	kW	Single stage heat output and no room temperature control	No
In standby mode	eISB	0	kW	Two or more manual stages, no room temperature control	No
			With mechanic thermostat room temperature control		YES
			With electronic room temperature control		No
			Electronic room temperature control plus day timer		No
			Electronic room temperature control plus week timer		No
			Other control options (multiple selections possible)		
			Room temperature control, with presence detection		No
			Room temperature control, with open window detection		No
			with distance control option		No
Contact details	Super Tech Health Ltd, 129 Shady Lane Birmingham B44 9ER, United Kingdom				



700W Oil Filled Radiator | Model NO: PM 807

Super Tech Health Limited
129 Shady Lane
Great Barr
Birmingham
West Midlands
B44 9ER
United Kingdom

WWW.PUREMATE.CO.UK