

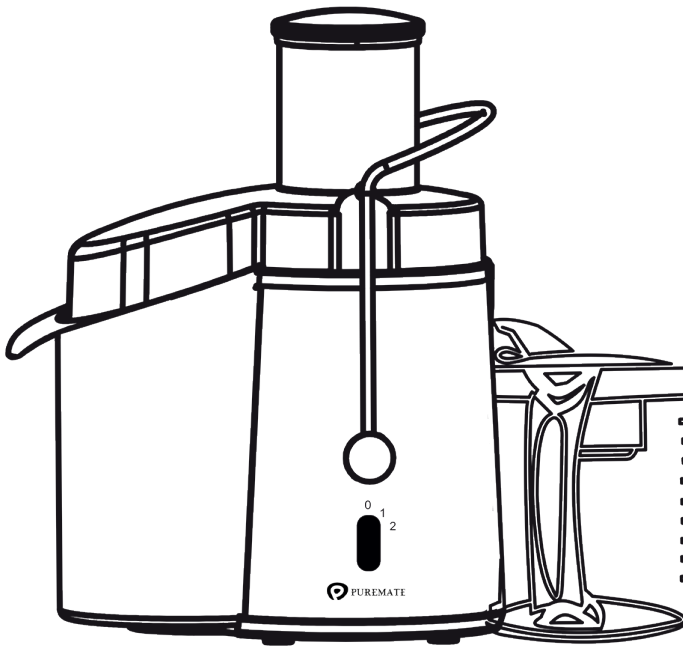

NaturoPure 1000W Centrifugal Juicer Machine

MODEL NO: PM-302





INSTRUCTION MANUAL

WARNING!

Ensure that all safety precautions are followed when using electrical appliances for the proper operation of the device. This instruction booklet describes the safety precautions to be observed during operation to prevent injuries to yourself, other persons and damage to the device. The content not only is suitable for this product but also suitable for electrical appliances in general.

SYMBOLS EXPLAINED

	For indoor use only.		Please read instruction manual and retain for future use.
	Equipment complies with the applicable EU safety requirements and regulations.		

IMPORTANT!

Do Not Use This NaturoPure 1000W juicer Until You Have Read This Entire Manual Thoroughly and Keep in a safe place for future reference.

THANK YOU

FOR BEING OUR CUSTOMER

Thank you for purchasing the innovative product the PureMate NaturoPure 1000W Juicer Maker

We wish you many years of health with this efficient and effective product.

SAFETY INSTRUCTIONS

◎ AC 220~240V/50~60Hz.

Over Voltage may cause fire hazard or electric shock.

◎ To prevent electric shock, do not dismantle, repair or modify this product freely. Maintenance and cleaning shall be processed as exactly as instructed in this manual. In case of malfunction, please contact the authorized maintenance center.

◎ Do not use in place where flammable and explosive materials are stored.

◎ Do not subject the device to direct sunlight or near high temperature objects. Internal temperature rise in serious cases may cause fire, in mild cases may cause deformation of the outer casing. (Stop operation when ambient temperature exceeds 40°C)

◎ To prevent fire or electric shock hazard, do not place the unit in wet places where water may enter the device.

◎ Do not use fabrics or other materials to cover this device. Obstructed air inlets and outlets will result in abnormal operation of this device that may lead to fire or other accidents.

◎ To prevent interference and distortion, the device should be placed at least 1 meter away from the computer, television or radio.

◎ For safety reasons and to prevent fire or electric shock, unplug the power cord from the electric outlet socket under the following conditions:

- When you do not use the device for a long period.
- When cleaning, servicing the machine or during replacement of filter materials.
- When you move the device.

CAUTION

If the power cord is damaged, it must be replaced by an authorized service personnel in order to avoid electric shocks and fire hazards.

COMPONENTS

- A. Pusher
- B. Feeding tube
- C. Lid
- D. Filter
- E. Juice collector
- F. Pulp container
- G. Clamps
- H. Control knob
- I. Driving Shaft
- J. Motor Unit

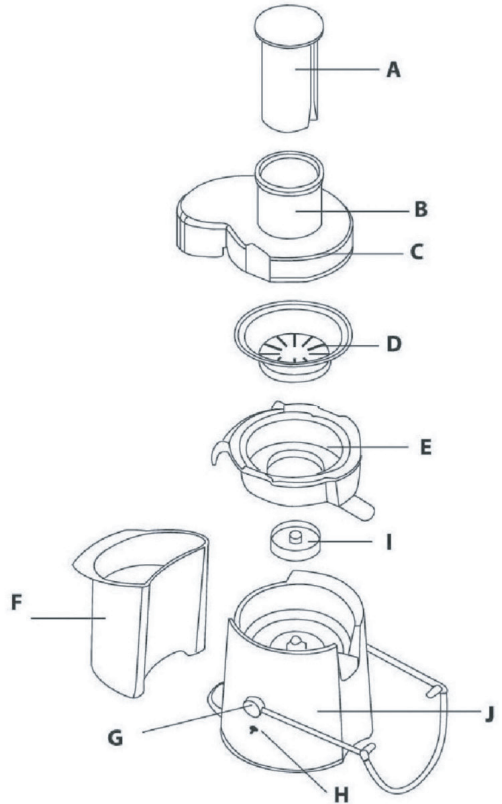

OPERATING INSTRUCTIONS

Please thoroughly clean all the parts that will come into contact with food before you use the appliance for the first time..

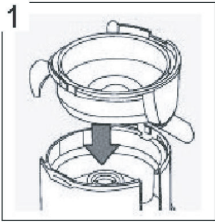

Place the juice collector into the appliance.

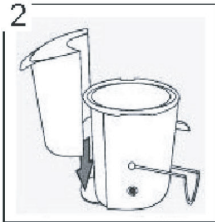

Place the pulp container by tilting it forwards slightly.

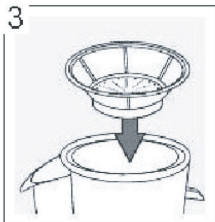

Put the filter in the juice collector.

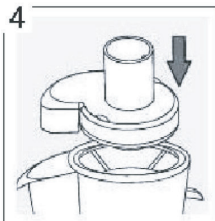

Hold the lid over the filter and lower it into position.

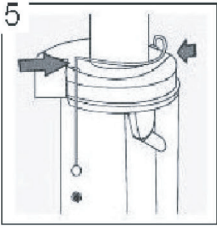

Snap the two clamps onto the lid to lock it into place ('click').

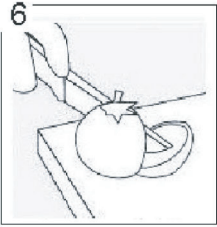

Wash the fruit and/ or vegetable and cut them into pieces that fit into the feeding tube.

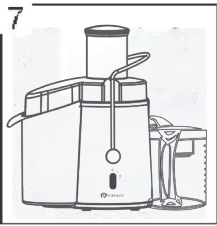

Make sure the juice jug has been placed under the spout.

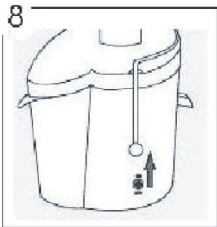

Turn the control knob to setting 1 (low speed) or 2 (normal speed) to switch on the appliance

a. Speed 1 is especially suitable for soft fruits and vegetables such as watermelons, grapes, tomatoes, cucumbers and raspberries.

b. Speed 2 is suitable for all kinds of fruits and vegetables.

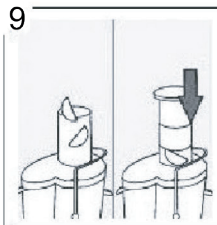

9. Put the pre-cut pieces in the feeding tube and gently press them down towards the rotating filter with the pusher.

10. After you have processed all ingredients and the juice flow has stopped, switch off the appliance and wait until the filter has stopped rotating.

CAUTION

Do not exert too much pressure on the pusher, as this could affect the quality of the end result and it could even cause the filter to come to a halt.

CAUTIONS

- ⦿ Do not immerse the motor unit in water or any other liquid, nor rinse it under the tap.
- ⦿ Check if the voltage indicated on the base of the appliance corresponds to the local mains voltage before you connect the appliance.
- ⦿ Do not use the appliance if the plug, cord or any other components are damaged.
- ⦿ The damaged cord must be replaced before re-using.
- ⦿ This appliance is not intended for use by persons (including children) with reduced physical, sensory or mental capabilities, or lack of experience and knowledge, unless they have been given supervision or instruction concerning use of the appliance by a person responsible for their safety.
- ⦿ Children should be supervised to ensure that they do not play with the appliance.
- ⦿ Never let the appliance operate unattended.

- ⦿ Never reach into the feeding tube with your fingers or an object while the appliance is running. Only use the pusher for this purpose.

- ⦿ This appliance is intended for household use only.

- ⦿ Make sure all parts are correctly mounted before you switch on the appliance. Only use the appliance when both clamps are locked.

- ⦿ Only unlock the clamps after you have switched off the appliance and the filter has stopped rotating.

- ⦿ Do not operate the juicer for more than 30 seconds at a time when juicing heavy loads and let it cool down sufficiently afterwards.

- ⦿ Do not remove the pulp container when the appliance is operating.

- ⦿ Always unplug the appliance after use.

TIPS

- ◎ Use fresh fruits and vegetables, as they contain more juice. Pineapple, beet roots, celery stalks, apples, cucumbers, carrots, spinach, melons, tomatoes, pomegranates, oranges and grapes are particularly suitable for processing in the juice extractor.
- ◎ You do not have to remove thin peels or skins. Only thick peels, e.g. those of oranges, pineapples and uncooked beetroots need to be removed. Also remove the white pith of citrus fruits because it has a bitter taste.
- ◎ Apple juice turns brown very quickly. To slow down this process, add a few drops of lemon juice.
- ◎ Fruits that contain starch, such as bananas, papayas, avocados, figs and mangoes are not suitable for processing in the juice extractor. Use a food processor, blender or to process these fruit.
- ◎ Leaves and leaf stalks of e.g. lettuce can also be processed in the juice extractor.
- ◎ Drink the juice immediately after you have extracted it. If it is exposed to air for some time, the juice will lose its taste and nutritional value.
- ◎ To extract the maximum amount of juice, always press the pusher down slowly.
- ◎ The juicer is not suitable for processing very hard and/or fibrous/starchy fruits or vegetables such as sugar cane.

CLEANING AND MAINTENANCE

The appliance is easier to clean if you do so immediately after use.

1. Unplug the appliance before cleaning.
2. Remove the pulp container and pusher, open the clamps and then remove the lid.
3. Remove the juice collector together with the filter.
4. Clean these parts by hand in warm water with some washing liquid and rinse them under the tap.
5. Clean the motor unit with a damp cloth.

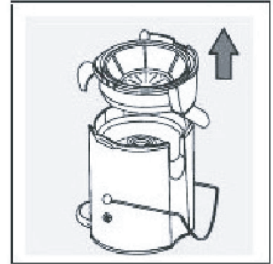



SPECIFICATIONS

Model:	PM-302
Rated Voltage:	AC 220~240V/50Hz.
Motor output:	1000 W
Motor Speed:	14000-18000 RPM
Dimensions:	30.0 (L) x 20.0 (W) x 40.0 (H) (cm)
Weight:	3.6 kg)

WARRANTY & SERVICE

Items purchased directly with PureMate, or one of our approved resellers, you will automatically register your warranty for 1 (ONE) year. You do not require to register again for your warranty. All warranties will execute our terms and conditions you will find these via our website at www.puremate.co.uk

DISPOSAL OF THE DEVICE

	Waste Electrical and Electronic Equipment (WEEE)	This symbol on the product and/or packaging indicates that Waste Electrical product (WEEE) under Directive 2012/19/ EU which governs used electrical and electronic appliances, should not be disposed of with general household waste.
	The Mobius Loop	This symbol indicates that the product or packaging is capable of being recycled.

FIND US ONLINE





**NaturoPure 1000W Juicer Machine Whole
Fruit/Vegetable Juice Maker**

Model NO: PM 302

Super Tech Health Limited
129 Shady Lane
Great Barr
Birmingham
West Midlands
B44 9ER
United Kingdom

WWW.PUREMATE.CO.UK

© Copyright 2021