

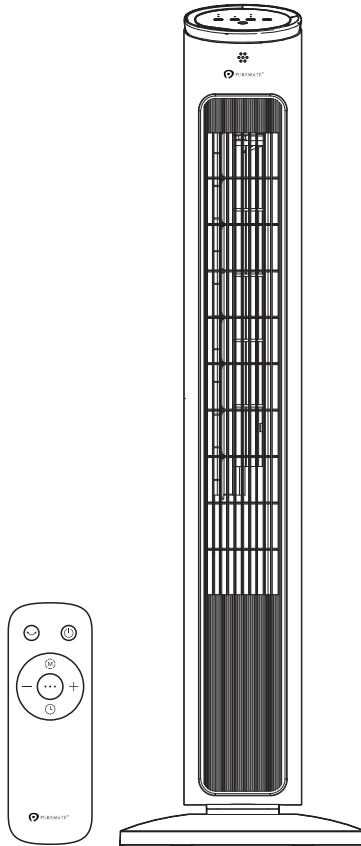

# 43 INCH OSCILLATING TOWER FAN

MODEL NO: PM 760





## INSTRUCTION MANUAL

## **⚠ WARNING!**

Ensure that all safety precautions are followed when using electrical appliances for the proper operation of the device. This instruction booklet describes the safety precautions to be observed during operation to prevent injuries to yourself, other persons and damage to the device. The content not only is suitable for this product but also suitable for electrical appliances in general

Do Not Use This Tower Fan Until You Have Read This Entire Manual Thoroughly and Keep in a safe place for future reference.

## **SYMBOLS EXPLAINED**

	For indoor use only.		Please read instruction manual and retain for future use.
	Equipment complies with the applicable EU safety requirements and regulations.		

## **IMPORTANT!**

Do Not Use This Tower Fan Until You Have Read This Entire Manual Thoroughly and Keep in a safe place for future reference.

This product is only suitable for well insulated spaces or occasional use.

# **THANK YOU**

F O R B E I N G O U R C U S T O M E R

Thank you for purchasing the innovative product the PureMate 43 Inch Oscillating Tower Fan. We wish you many years of healthy air with this efficient and effective product.

## **SAFETY OPERATION**

- Ensure that all safety precautions are followed when using electrical appliances for the proper operation of the safety device. This instruction booklet describes the safety precautions to be observed during operation to prevent injuries to yourself, other persons and damage to the device. The content not only is suitable for this product but also electrical appliances in general.

## **SAFETY INSTRUCTION**

- To avoid fire or shock hazard, plug the appliance directly into a 220-240V AC electrical outlet.
- Disconnect the power plug before dismantling, assembling or before cleaning.
- Keep unit away from heated surfaces and open flames.
- To protect against electrical hazards, DO NOT immerse in water or other liquids. Do not use near water.
- Children cannot recognize the hazards associated with the usage of electrical appliances. For this reason, always supervise children when they are near the unit.
- Always unplug the tower fan before moving, cleaning or whenever the tower fan is not in use. Be sure to pull by the plug and not the cord.
- NEVER drop or insert any object into any openings.

- DO NOT run cord under carpeting. DO NOT use outdoors.
- DO NOT cover cord with throw rugs, runners, or similar coverings.
- DO NOT route cord under furniture or appliances. Arrange cord away from traffic area and where it will not be tripped over.
- DO NOT operate any appliance with a damaged cord or plug, if motor fan fails to rotate, after the appliance malfunctions, or if it has been dropped or damaged in any manner. Please Call Customer Service for assistance.
- DO NOT attempt to repair or adjust any electrical or mechanical functions on this unit. Doing so will void your warranty. The inside of the unit contains no user serviceable parts. All servicing should be performed by qualified personnel only.
- Do not operate the appliance with wet hands, in order to avoid damage.
- DO NOT knock or shake the body of the tower fan when in use, otherwise it may cause the item to stop.
- NEVER insert fingers, pencils or any other objects through the guards.
- DO NOT use the appliance for any other purpose than its intended use.
- The fan must not be used if the casing is damaged or open.

# COMPONENTS

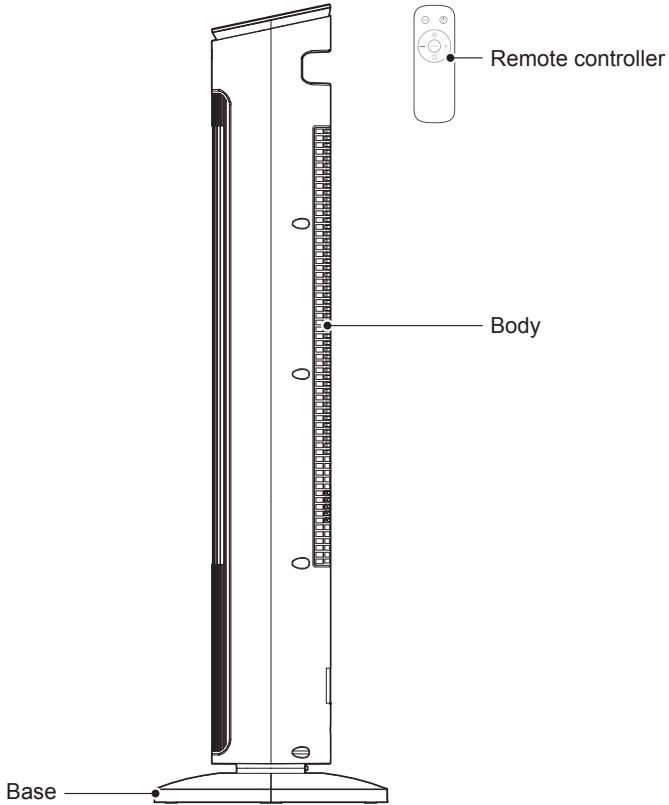

## **NOTE**

All the pictures in this manual are for explanation purpose only. Any discrepancy between the real object and the illustration in the drawing shall be subject to the real subject.

# CONTROL PANEL AND REMOTE CONTROL

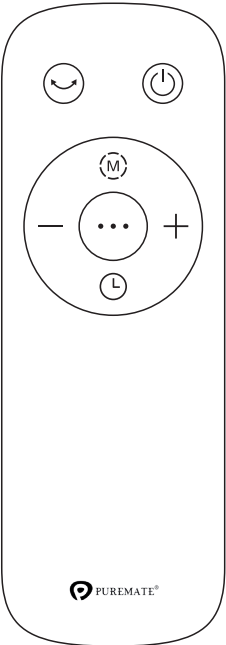
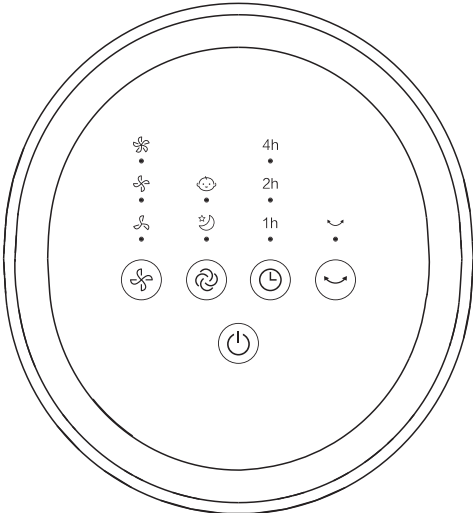

# ASSEMBLY INSTRUCTIONS

## NOTE

Please place the machine on the package foam or other soft surfaces and invert it to avoid scratch mark when assembling the base.

1. Take out the two parts of the base from packing box. Then, align the centers of the two parts of the base and place them in a crossed form. Rotate one of the two bases to align its hole site and make it stuck correctly.

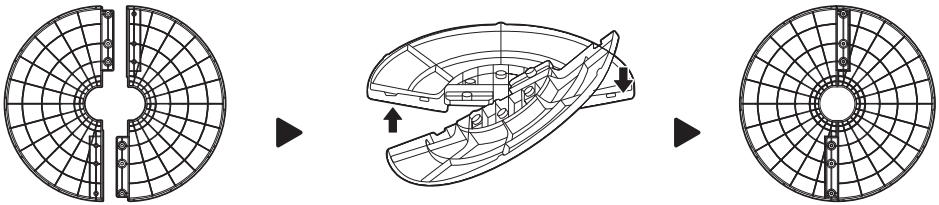

2. Detach the plastic nut from the fan body.

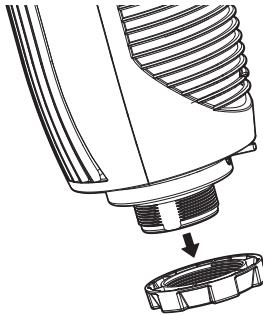

3. Remove the pole, and then directly fix the fan body to the base with a plastic nut.

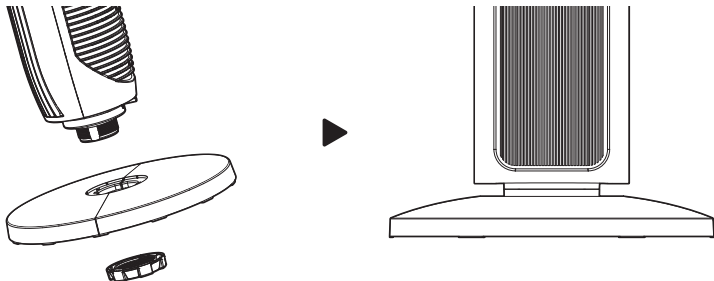

# OPERATING INSTRUCTIONS

ON/OFF: “”

Press this to switch on/switch off the fan.

OSCILLATION: “”

After the fan has started, press this key to select oscillation mode. The lights on the display can indicate fan oscillation mode.



TIMER: “”

Press to select the amount of time which you would like the device to run before it stops automatically. Increase in increments up to “0-1-2-3-4-5-6-7-0” hours.

SPEED: “” Press to adjust between 3 fan speeds.

- Low
- Medium
- High

MODE: “” Press to choose between 3 different modes:

- Normal Wind: The fan will blow continuously at any speed you select.
- SLEEP: “” The fan speed will gradually lower to Low over a 30 minute period. Speed cannot be manually adjusted.
- BABY: “” The fan will imitate a gentle natural breeze, which will increase and decrease wind power continuously.



# REMOTE CONTROL

Requires 2 X AAA 1.5V batteries. Used batteries must be safely disposed.  
Respect the polarity when inserting. Direct it to the front of the fan

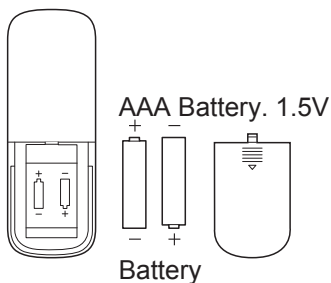

## BATTERIES INSTALLATION

Battery not included in the packaging

1. Slide the battery compartment cover.

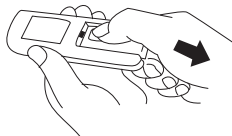

Fig 1

2. Insert the batteries, and make sure that the batteries are placed as shown in the Fig 2.

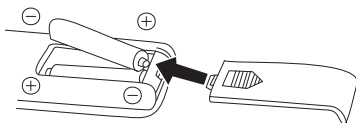

Fig 2

3. Slide back the battery cover.

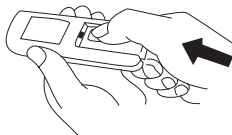

Fig 3

### NOTE

Use manganese or alkaline batteries of type "AAA". DO not use rechargeable

# CLEANING AND MAINTENANCE

The fan requires little maintenance. Do not try to fix it by yourself. Refer it to qualified service personnel if service is needed.

1. Before cleaning and assembling, fan must be unplugged.
2. To ensure adequate air circulation to the motor, keep vents at the rear of the motor free of dust. Do not disassemble the fan to remove dust.
3. Please wipe the exterior parts with a soft cloth soaking a mild detergent.
4. Do not use any abrasive detergent or solvents to avoid scratching the surface. Do not use any of the following as a cleaner: gasoline, thinner.
5. Do not allow water or any other liquid into the motor housing or interior parts.
6. Be sure to unplug from the electrical supply source before cleaning.
7. Plastic parts should be cleaned with a soft cloth moisten with mild soap. Thoroughly remove soap film with dry cloth.

# TROUBLESHOOTING

Incorrect operation of your appliance can lead to errors and malfunctions. The following tables contain possible causes and notes for resolving an error message or malfunction. It is recommended to read the table below carefully in order to save your time and money that may cost for calling to the service center.

Problem	Cause	Solution
The machine does not work properly after installed	• The power cable is not plugged in or has poor contact.	Make sure the plug is properly inserted into the socket.
	• The switch on the body is not turned on.	Turn on the switch on the body.
The remote does not work	• The battery needs replacing.	Replace the battery.
	• The remote is being used more than 5m away from the fan.	Use the remote closer to the fan and make sure it is pointing directly at the control panel.



# WARRANTY & SERVICE

Items purchased directly with PureMate, or one of our approved resellers, you will automatically register your warranty for 1 (ONE) year. You do not require to register again for your warranty. All warranties will execute our terms and conditions you will find these via our website at [www.puremate.co.uk](http://www.puremate.co.uk)

# SPECIFICATION

Model :	PM- 760
Rated Voltage :	220-240v~50Hz
Power Consumption:	40W
Product size:	230x199x1140mm
Net Weight:	3.5 Kg
Certifications:	UKCA, CE, Rohs
Warranty:	1 Year

# DISPOSAL OF THE DEVICE

	<p>Waste Electrical and Electronic Equipment ( WEEE )</p>	<p>This symbol on the product and/or packaging indicates that Waste Electrical product ( WEEE ) under Directive 2012/19/ EU which governs used electrical and electronic appliances, should not be disposed of with general household waste.</p>
	<p>The Mobius Loop</p>	<p>This symbol indicates that the product or packaging is capable of being recycled.</p>

# FIND US ONLINE





**43 INCH OSCILLATING TOWER FAN | MODEL NO: PM-760**

Super Tech Health Limited  
129 Shady Lane  
Great Barr  
Birmingham  
West Midlands  
B44 9ER  
United Kingdom

**[WWW.PUREMATE.CO.UK](http://WWW.PUREMATE.CO.UK)**